

MAP REF. 109-5-SE

MAP REF. 109-9-NE

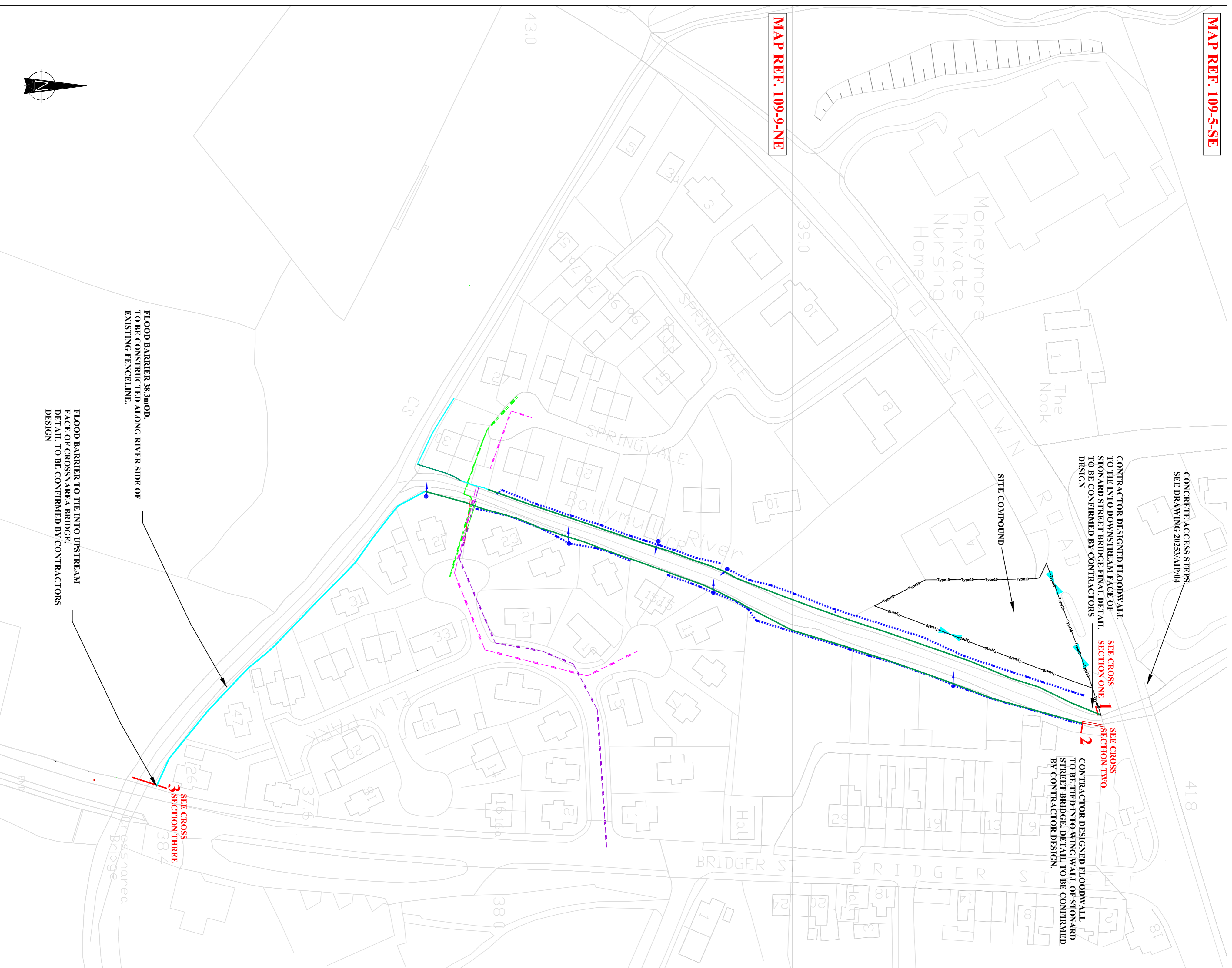

NOTES

1. ALL DIMENSIONS ARE IN mm UNLESS OTHERWISE STATED
2. ALL LEVELS TO ORDNANCE DATUM BELFAST
3. THE CONTRACTOR SHALL TAKE ALL NECESSARY PRECAUTIONS TO AVOID CAUSING ANY UNWARRANTED DAMAGE AS TO CL. 113 OF THE SPECIFICATION.
4. THE BALLYMULLY RIVER IS A SIGNIFICANT RIVER FOR FISH SPAWNING AND IT WILL BE THE CONTRACTORS RESPONSIBILITY TO ENSURE THAT THERE IS NO SPILLAGE OF SEDIMENT OR OTHER POLLUTANTS TO THE WATERCOURSE.
5. SETTING OUT SHALL BE AGREED ON SITE WITH THE CONTRACT ADMINISTRATOR.
6. THE CONTRACTOR MAY NOT ENRODCH BEYOND THE LIMITS OF THE WORKING AREA WITHOUT THE PRIOR WRITTEN APPROVAL OF THE LANDOWNER AND THE PROJECT MANAGER
7. WORKING WITHIN OR FROM THE RIVER CHANNEL IS NOT PERMITTED FROM 1st NOVEMBER TO MID APRIL. SEE THE SITE SPECIFIC WORKS INFORMATION.
8. TYPE 10 FENCING SHALL BE USED TO ENCLOSE ALL OPEN EXCAVATIONS.
9. RIVER BANKS AND WORKING AREA TO BE CLEARED OF VEGETATION AND OTHER OBSTRUCTIONS AS DUTLINED WITHIN THE INDIVIDUAL RIPARIAN LAND MAPS. FULL EXTENT OF TREE / SHRUB REMOVAL FROM THE RIVERBANKS / WORKING AREA TO BE AGED ON SITE WITH THE CONTRACT ADMINISTRATOR. EFFORTS SHOULD BE MADE TO RETAIN SOME VEGETATION COVER TO THE AREA.
10. CONTRACTOR TO RECORD THE EXACT POSITION OF ALL EXISTING WALLS, FENCES, GATES, HEDGES, BOUNDARIES AND PERTINENT FEATURES WITHIN THE WORKING AREA AND ENSURE REINSTATEMENT OF ALL IN THEIR ORIGINAL LOCATION.
11. ANY NECESSARY TRIMMING OR FELLING OF TREES MUST BE CARRIED OUT BY A SPECIALIST CONTRACTOR (TO THE APPROVAL OF THE PROJECT MANAGER) TO BS 3998 1989 IN ACCORDANCE WITH CLAUSE 310 OF THE SPECIFICATION.
12. TREE, BUSH AND SHRUB CLEARANCE IS NOT PERMITTED FROM MARCH TO AUGUST. SEE THE SITE SPECIFIC WORKS INFORMATION.
13. ALL OVERHANGING BUSHES, TREES AND VEGETATION TO BE LOPPED BY HAND AS DIRECTED BY THE CONTRACT ADMINISTRATOR.
14. TOPSOIL, STRIPPED FROM AGRICULTURAL LAND, RIVERBANK AND PRIVATE GARDENS MUST BE SEGREGATED IN SEPARATE STOCK PILES AND ONLY UTILISED FOR REINSTATEMENT IN ITS LOCATION OF ORIGIN.
15. ALL IMPROVED TOPSOIL REQUIRED FOR REINSTATEMENT TO BE SANDY-LOAM TOPSOIL TO BS 3882 SPECIFICATION.
16. SURPLUS SPOIL SHALL NOT BE DISPOSED OF WITHIN THE FLOODPLAIN BUT DISPOSED AS PER CLAUSE 136
17. THE CONTRACTOR MUST ENSURE THE WORKING AREA IS SECURELY FENCED AT ALL TIMES IN ACCORDANCE WITH CLAUSES 19 AND 2146 OF THE SPECIFICATION
18. FLOOD BARRIER TO BE DESIGNED BY THE CONTRACTOR IN ACCORDANCE WITH THE SPECIFICATION (SEE PART TWO, WORKS INFORMATION, SITE SPECIFIC WORKS INFORMATION).
19. AS PART OF CHANNEL REINSTATEMENT FISHERIES ENHANCEMENT MEASURES ARE REQUIRED.

SITE PLAN
SCALE 1:1000

LEGEND

	FLOOD BARRIER TO THE INTO UPSTREAM FACE OF CROSSAREA BRIDGE. DETAIL TO BE CONFIRMED BY CONTRACTORS DESIGN
	FLOOD BARRIER TO BE CONSTRUCTED ALONG RIVER SIDE OF EXISTING FENCELINE.
	FLOOD BARRIER TO BE CONSTRUCTED ALONG RIVER SIDE OF EXISTING FENCELINE.
	FLOOD BARRIER TO BE CONSTRUCTED ALONG RIVER SIDE OF EXISTING FENCELINE.
	FLOOD BARRIER TO BE CONSTRUCTED ALONG RIVER SIDE OF EXISTING FENCELINE.
	FLOOD BARRIER TO BE CONSTRUCTED ALONG RIVER SIDE OF EXISTING FENCELINE.
	FLOOD BARRIER TO BE CONSTRUCTED ALONG RIVER SIDE OF EXISTING FENCELINE.
	FLOOD BARRIER TO BE CONSTRUCTED ALONG RIVER SIDE OF EXISTING FENCELINE.
	FLOOD BARRIER TO BE CONSTRUCTED ALONG RIVER SIDE OF EXISTING FENCELINE.
	FLOOD BARRIER TO BE CONSTRUCTED ALONG RIVER SIDE OF EXISTING FENCELINE.
	FLOOD BARRIER TO BE CONSTRUCTED ALONG RIVER SIDE OF EXISTING FENCELINE.
	FLOOD BARRIER TO BE CONSTRUCTED ALONG RIVER SIDE OF EXISTING FENCELINE.
	FLOOD BARRIER TO BE CONSTRUCTED ALONG RIVER SIDE OF EXISTING FENCELINE.
	FLOOD BARRIER TO BE CONSTRUCTED ALONG RIVER SIDE OF EXISTING FENCELINE.
	FLOOD BARRIER TO BE CONSTRUCTED ALONG RIVER SIDE OF EXISTING FENCELINE.
	FLOOD BARRIER TO BE CONSTRUCTED ALONG RIVER SIDE OF EXISTING FENCELINE.
	FLOOD BARRIER TO BE CONSTRUCTED ALONG RIVER SIDE OF EXISTING FENCELINE.
	FLOOD BARRIER TO BE CONSTRUCTED ALONG RIVER SIDE OF EXISTING FENCELINE.
	FLOOD BARRIER TO BE CONSTRUCTED ALONG RIVER SIDE OF EXISTING FENCELINE.
	FLOOD BARRIER TO BE CONSTRUCTED ALONG RIVER SIDE OF EXISTING FENCELINE.
	FLOOD BARRIER TO BE CONSTRUCTED ALONG RIVER SIDE OF EXISTING FENCELINE.
	FLOOD BARRIER TO BE CONSTRUCTED ALONG RIVER SIDE OF EXISTING FENCELINE.
	FLOOD BARRIER TO BE CONSTRUCTED ALONG RIVER SIDE OF EXISTING FENCELINE.
	FLOOD BARRIER TO BE CONSTRUCTED ALONG RIVER SIDE OF EXISTING FENCELINE.
	FLOOD BARRIER TO BE CONSTRUCTED ALONG RIVER SIDE OF EXISTING FENCELINE.
	FLOOD BARRIER TO BE CONSTRUCTED ALONG RIVER SIDE OF EXISTING FENCELINE.

Rev:	Amendments:	Date:
Drawn by:	Date:	Scale:
Checked by:	Date:	Sheet Size:
Director of Development:	Project Manager:	
Project:		
Title:		

Drawn by: K.YARR Date: NOV 2006 Scale: AS SHOWN
 Checked by: J. CARLISLE Date: 2006 Sheet Size: A1
 Director of Development: J. Clarke B.Sc. C.Eng M.I.C.E.
 Project Manager: S. Dawson B.Sc. C.Eng M.I.C.E.

Project: MONEYHAW EXT./ BALLYMULLY RIVER FLOOD PROTECTION SCHEME MONEYMORE, PROJECT No: 20253
 Title: SITE PLAN

DRG. No. DU1/PROJ/2/AIP/01

Headquarters
 Hydrobank
 4 Hospital Road
 Belfast BT15 8JJ
 Telephone: 028 9025 3455
 Fax: 028 9025 3455

An Agency of the
 Department of Agriculture
 and Rural Development